

# Compact Valve Automation

421 BREADEN DR. #15

MONROE, OH 45050-1575

PH 513.539.1234

FX 513.539.2176



**Ultra-Compact**  
 Motor and valve direct coupled for miniature valve automation.

**Visual Position Indicator**

**Microprocessor Control Mode Option**  
 DC 3-5V single chip computer control option. Allows for the actuator to be run on a lithium battery circuit.

**Captive Cover Screws**

**Factory Calibrated to valve**

One piece cam for precise 90° travel. No cam adjustments necessary.

**Wide range of Power Inputs**  
 AC/DC 5, 12, 24, 110, 220

**Stainless, Bronze, or Plastic valves**

Integrally fit NPT valves. Specially designed low torque valves reduce power requirements.

**IP67 Design Housing Protection**

**Solenoid Replacement**

4-Wire, 3-wire and 2-wire hookup for bistable and monostable solenoid replacement.

**Flying Leads**  
 24" wire leads. 28Ga.

**Low Power Consumption**  
 Working current 60-80mA at 1~2Mpa (145~290psi) water pressure.

**Floating Seal**  
 Ultra-low seal construction of the ball and body allows for significantly reduced torque requirement.

**Standard Features:**

**2-Port or 3-Port Designs**  
 2-way and 3-way valves for custom flow control.



**Available for Steam Environment**

Series can work in steam for long periods due to vent and circuit that can resist dampness.



**Custom Control Boxes, Relays, feedback sensors,...**

Consult factory for custom electrical requirements.

**Compact - Reliable:**

**Options:**

# Superior Valve Automation



421 BREADEN DR. #15

MONROE, OH 45050-1575

PH 513.539.1234

FX 513.539.2176

Performance:  
Dimensional:

Item	Configuration	Parameter	Unit
Supply Voltage		AC/DC 12 24	V
		110 220	
Working current	1.0Mpa 200L/H	DC 3-5V	20 60±10
			20 80±10
	AC/DC 12V/24V	40	
	AC/DC 110V/220V	15	
	Static current	DC 3-5V	0
	DC 12/24V	12	
	DC 110/220V	12	
Pressure rating		1.6	Mpa
Supply pressure		2.5	Mpa
Humidity		<98	%
Temperature Range			
Rotation direction		Double acting	
Actuator rotation		90°	
Opening/Closing time		5 7	s
Input Power	3-5V	MAX 2.5	Watt
	12V/24V	MAX 3	
	110V/220V	MAX 6	
Enclosure Rating		IP67	
Actuator Torque		2	NM

Aperture mm	Interface specification	Flow(m <sup>3</sup> /hr)					
		1.5	2.5	3	3.5	5	7
15	DN15 DN 20 DN25	0.0012	0.0034	0.005		0.0015	
20	DN25 DN32			0.0007	0.001	0.002	0.004

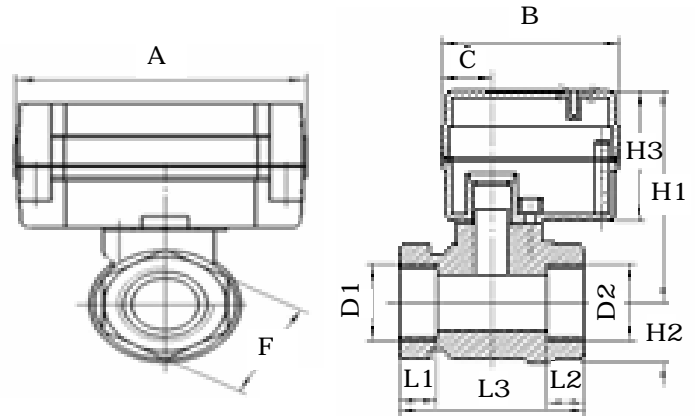

Specification	A	B	C	E	F	H1	H2	H3	L1	L2	L	D1	D2	W(kg)	
Twd	DN15(1/2")	64	53	15	-	27	57.5	16.5	35.5 (45.5)	11	11	55	G1/2"	G1/2"	0.33
	DN20(3/4")	64	53	15	--	33	57.5	16.5	35.5 45.5	10	13	66	G3/4"	G3/4"	0.21
	DN25(1")	64	53	15	--	37	57.5	16.5	35.5 45.5	10	15	90	G1"	G1"	0.3
		64	53	15	--	38	61 71	21.5	35.5 45.5	12.5	15	81	G1"	G1"	0.5
	DN32 1-1/4"	64	53	15	--	49	61 71	24	35.5 45.5	14	15	81	G11/4"	G11/4"	0.54
Tee	DN15(1/2")	64	53	15	26	27	57.5	16.5	35.5 (45.5)	11	11	55	G1/2"	G1/2"	0.36
	DN20(3/4")	64	53	15	30	33	57.5	16.5	35.5 45.5	10	13	66	G3/4"	G3/4"	0.41
	DN25(1")	64	53	15	51.5	37	57.5	16.5	35.5 45.5	10	15	90	G1"	G1"	0.54

## EV and NV Series

See Bulletins B00010 and B00020 for smaller sized electric actuators from Valvsys. Torques from 125 inlbs to 1,000 inlbs.

## Control Boxes

NEM4, NEMA 7, and non-metallic control boxes for on/off, remote control, "jogging", and other specific and custom wired functions. Consult Factory.

Options:

While the information contained in this literature is believed to be accurate it is supplied for informative purposes only and should not be considered certified or as a guarantee of satisfactory results by reliance thereon. Nothing contained herein is to be construed as a warranty or guarantee, express or implied, regarding any matter with respect to this product. Products may differ as the result of Valvsys, LLC policy of continuous product improvement.



www.valvsys.com  
info@valvsys.com

Valvsys, LLC  
421 Breaden Dr., #15  
Monroe, OH 45050  
ph 513.539.1234  
fx 513.539.2176